

DIMENSIONS & RECOMMENDED PATTERN

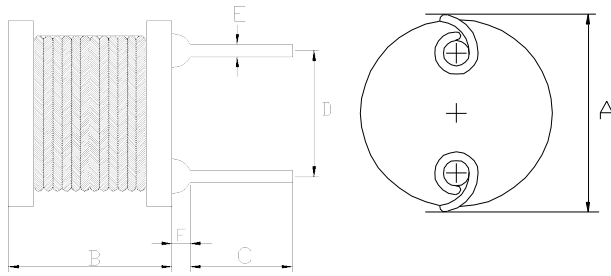

A:	5.0Max.	mm
B:	6.0Max.	mm
C:	15±2.0	mm
D:	2.0±0.5	mm
E:	φ0.5±0.1	mm
F:	2.0Max.	mm

※FEATURE

Applications:DC-DC converters,LCD Set,OA equipment,notebook, PDA

SELECTION GUIDE FOR STANDARD COILS:

MAGLAYERS PT/NO.	Inductance L(μH)	Percent Tolerance	Test Frequency	Resistance RDC(Ω)Max.	Rated DC Current
					IDC1(A)
GDR-0405-1R5□	1.5	M	100kHz/0.25V	34m	3.6
GDR-0405-2R2□	2.2	M	100kHz/0.25V	40m	3.0
GDR-0405-3R3□	3.3	M	100kHz/0.25V	58m	2.5
GDR-0405-4R7□	4.7	M	100kHz/0.25V	72m	2.2
GDR-0405-5R6□	5.6	M	100kHz/0.25V	81m	2.0
GDR-0405-6R8□	6.8	M	100kHz/0.25V	87m	1.8
GDR-0405-8R2□	8.2	M	100kHz/0.25V	0.108	1.6
GDR-0405-100□	10	K,M	100kHz/0.25V	0.124	1.5
GDR-0405-270□	27	K,M	100kHz/0.25V	0.330	0.90
GDR-0405-330□	33	K,M	100kHz/0.25V	0.375	0.85
GDR-0405-390□	39	K,M	100kHz/0.25V	0.460	0.80
GDR-0405-820□	82	K,M	100kHz/0.25V	1.105	0.50
GDR-0405-101□	100	K,M	100kHz/0.25V	1.431	0.46
GDR-0405-151□	150	K,M	100kHz/0.25V	1.770	0.37
GDR-0405-181□	180	K,M	100kHz/0.25V	1.815	0.35
GDR-0405-102□	1000	K,M	100kHz/0.25V	10.20	0.14

※GENERAL SPECIFICATION:

※□specify the inductance tolerance,K(±10%),M(±20%)

※IDC1 : Based on inductance change ($\Delta L/L_0 : \leq \text{drop}10\%$) @ ambient temp. 25°C

IDC2 : Based on temperature rise ($\Delta T : 40^\circ\text{C TYP.}$) Rated DC

Current : The less value which is IDC1 or IDC2.